



## LAUREL

**4** BEDROOM **3½** BATH

### CLASSIC SOUTHERN COTTAGE

A dramatic entry leads to the large living area, open to both the kitchen and breakfast room. Just off the kitchen, a screened porch invites relaxation and al fresco dining. A generous master suite includes separate shower and a large walk-in closet. The three upper bedrooms share two generous baths.

---

**Orchards**  
at Squire Creek



# LAUREL HOME FEATURES

## SQUARE FOOTAGE

Main Level Heated Square Feet:	1,832
Upper Level Heated Square Feet:	995
Total Heated Square Feet:	2,827
Porches Square Footage:	604

## HOME HIGHLIGHTS

Main level master with 3 bedrooms up  
GE Stainless steel appliances  
Stone countertops  
Butler's pantry  
Home office  
Large screened porch  
Generous master closet  
Garage with spacious storage  
Utility/laundry room

## LANDSCAPE

Sodded front and rear yards  
Shade trees  
Irrigation system

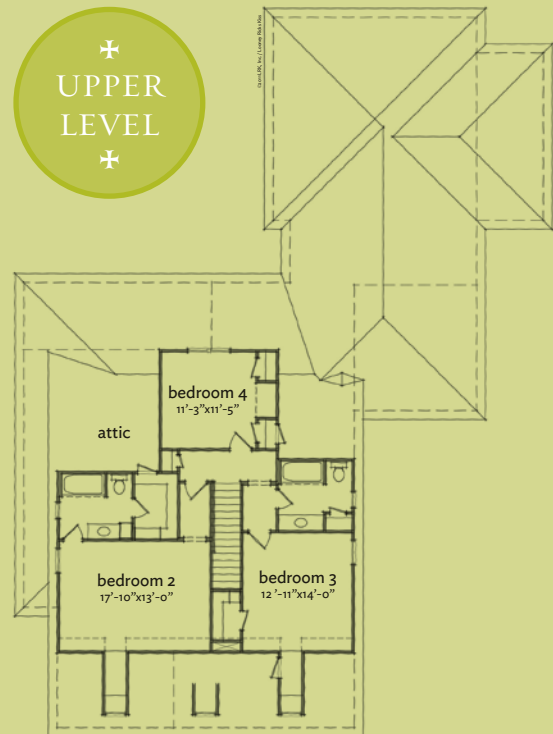

D-1

Orchards  
at Squire Creek

Architectural rendering may not reflect the final details or landscaping of the completed home. Renderings are artist depictions and may differ from completed construction. Dimensions are subject to revision without notice. Rendering art copyright Open Air Architecture 2011. Plan copyright Looney Ricks Kiss.